

ADJUSTABLE STEEL GANTRY CRANE - KNOCKDOWN - AHSN-10-15-10

APPROX WEIGHT: 1001.63 lbs.
DOES NOT INCLUDE WEIGHT OF POWER OR PACKAGING!!!

*** ANY ADDITIONS, DELETIONS, OR OMISSIONS MUST BE CORRECTED ON THIS DRAWING AS THIS DRAWING WILL BE CONSIDERED ALL INCLUSIVE ***

ALL GRAPHICS PROVIDED ARE FOR REFERENCE ONLY. IF CERTAIN DIMENSIONS ARE CRITICAL PLEASE VERIFY THOSE DIMENSIONS WITH YOUR SALESPERSON

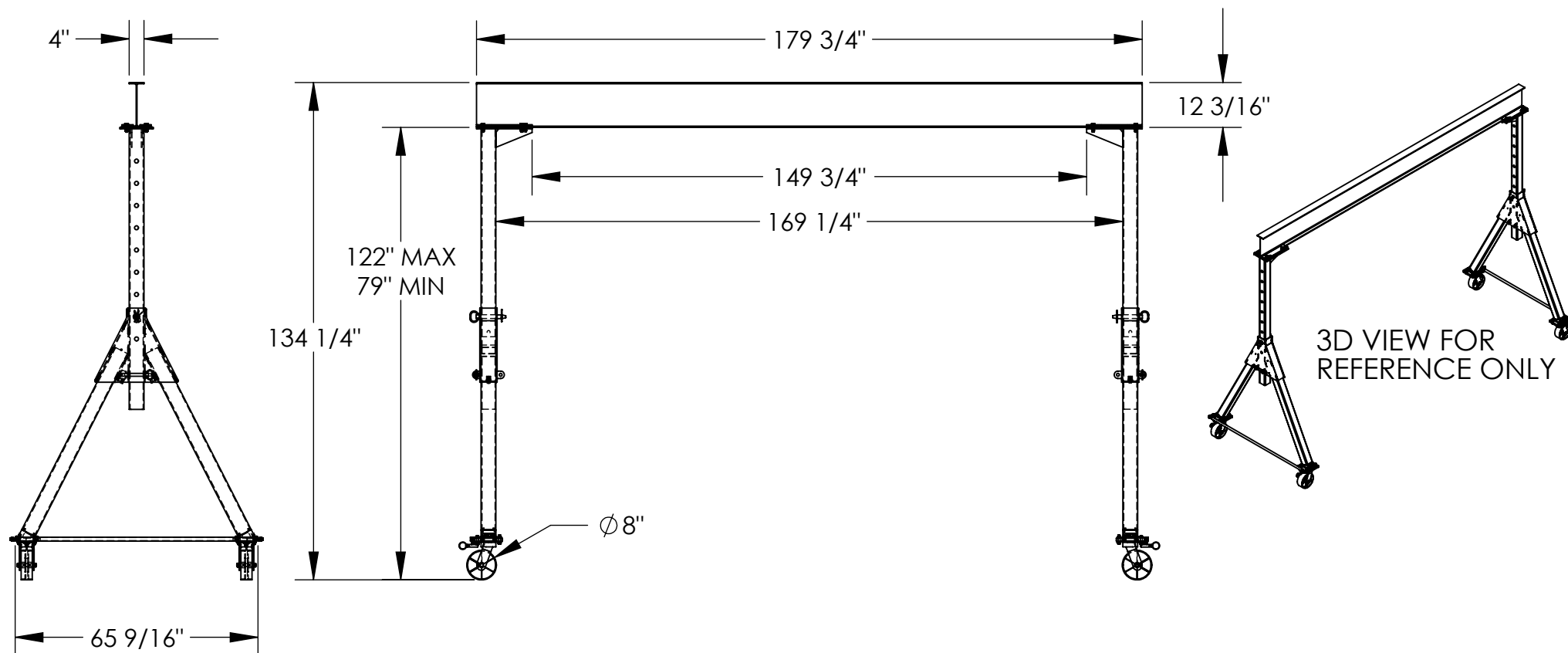

STANDARD FEATURES

MODEL NUMBER IS AHSN-10-15-10
CAPACITY IS 10,000 LBS.

BASE WIDTH IS $65 \frac{9}{16}$ "

MAX OVERALL HEIGHT IS $134 \frac{1}{4}$ "

I-BEAM HEIGHT IS $12 \frac{3}{16}$ "

I-BEAM FLANGE WIDTH IS 4"

OVERALL I-BEAM LENGTH IS $179 \frac{3}{4}$ "

USABLE I-BEAM LENGTH IS $149 \frac{3}{4}$ "

ADJUSTABLE UNDER I-BEAM HEIGHT

122" MAX

79" MIN

HEIGHT IS ADJUSTABLE IN 6" INCREMENTS

CASTERS: (4) $\varnothing 8$ " X 3" WIDE STEEL

SWIVEL CASTERS WITH FOUR

LOCKING POSITIONS

SPECIAL FEATURES

NONE

DIMENSION TOLERANCE $\pm \frac{1}{4}$ "

APPROVAL	I, THE UNDERSIGNED, AGREE THAT THE PRODUCT AS REPRESENTED SATISFIES DESIGN AND DIMENSION REQUIREMENTS. I ALSO ACKNOWLEDGE MY DUTY TO CONFIRM PRODUCT AND INSTALLATION COMPLIANCE WITH ALL APPLICABLE FEDERAL, STATE AND LOCAL REGULATIONS AND STANDARDS.	
	UNITS REQUIRING APPROVAL DRAWINGS OR MODIFIED ARE NON-RETURNABLE	
	[] As drawn [] As marked	
	Signed: _____ Date: _____	
Printed Name: _____		
LEAD TIME WILL START UPON RECEIPT OF SIGNED APPROVAL DRAWING		

DISTRIBUTOR'S NAME:		P.O.#
VESTIL MANUFACTURING		X
W.O.#		X
DRAWN BY: DLS	DATE: 07/23/2014	SALES: X
REFERENCE: X	SCALE: 1:40	FILE NAME:
QUOTED LEAD TIME: X	QUOTE # X	28-007-346